

RANGE OF PRODUCTS

K4.1 E-READY - CONCEALED SINGLE SHUT-OFF VALVE

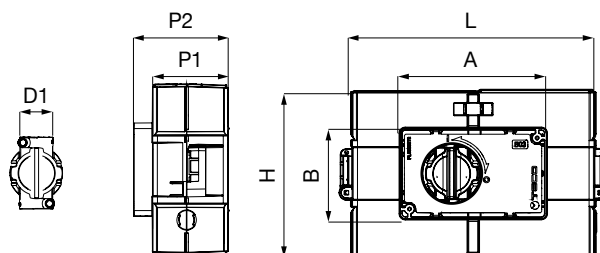
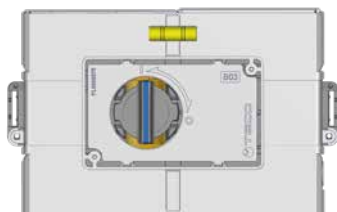

| Code | DN | D1 | L | H | P1 | P2 | A | B | Plate | Pack |
|-------------|----|-----|-------|-----|----|----|-------|----|-------|------|
| K401BF10300 | 15 | F13 | 198.5 | 136 | 60 | 75 | 118.7 | 74 | B03 | 5 |
| K401BF30200 | 20 | F14 | 198.5 | 136 | 60 | 80 | 118.7 | 74 | B03 | 5 |

Includes:

Pre-assembled box, fixing brackets, site protection, spirit level

Does not include:

Cover plate, fittings, motor and cable

Features

- Removable ball valve, with brass body and Top Entry system®, compliant with DIN EN 13828 with light “Soft Turn®” manoeuvring, complete with an inspectable box.
- Closing and opening by actuating the handle or set-up with E104 motor.
- Manually opening cover plate with magnetic closure, available in four finishes.

Field of use

- For hot and cold drinking water
- Domestic water systems

MATERIAL

| | |
|----------------|---------------|
| Body | Brass CW617N |
| Box | PS |
| Top-Entry Ball | Technopolymer |

TECHNICAL DATA

| | |
|----------------------------|---|
| Connections | FASTEC® |
| Operating pressure | PN10 (10 bar) |
| Temperature | 0 °C + 95 °C |
| Standard and certification | DIN EN 13828 - (KTW-W270) DVGW W 570-1 |

Flow loss diagram

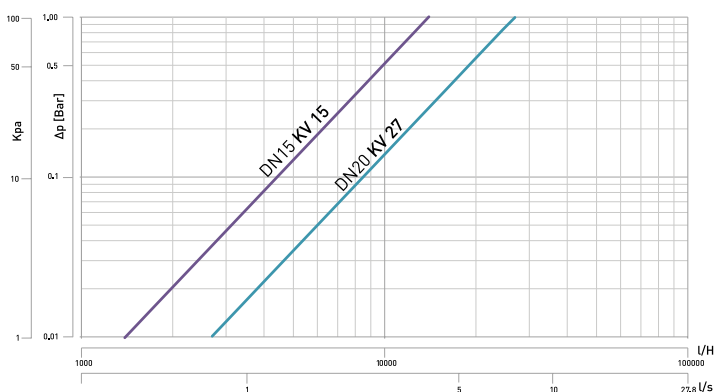

Connection:



FASTEC

F13 - DN15

Range of fittings:
16, 20, 25, 26 mm = 1/2"

F14 - DN20

Range of fittings:
25, 26, 32 mm = 3/4"

Specifications:

K4.1 E-READY Motorisable flush-mounting shut-off valve

Top Entry removable ball shut-off valve with full bore, compliant with DIN EN13828, pre-assembled in an inspectable sandwich box with pre-cut parts.

Technopolymer ball and “soft-turn” anti-blocking gaskets.

Including brackets and protective cover.

Closing and opening by actuating the handle.

Operating pin compatible with the mounting of the ON-OFF electric motor with auxiliary microswitch in the version with opening signal or in the version with safety feedback when the valve has closed.

COVER PLATE

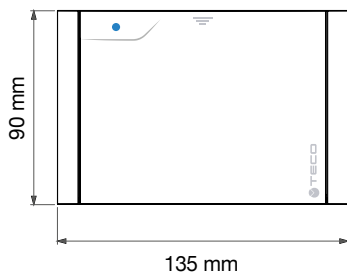

| Code | Finish | Pack |
|-------------|------------------|------|
| KPLB0301600 | White | 10 |
| KPLB0301M00 | Polished chrome | 5 |
| KPLB0301800 | Silver | 5 |
| KPLB0301A00 | Black Soft Touch | 5 |

Includes fixing materials

As indicated in the previous pages, the **Fastec**® fittings are found in the ranges of water system manufacturers (domestic water and thermal)



FASTEC® ADAPTERS

| Image | Drawing | Code | Description | D1 | D2 | Pack | |
|-------|---------|------------|----------------------|----|------|------|----|
| | | RF12210100 | Elbow fitting | | F13M | F13F | 10 |
| | | RF22220100 | Elbow fitting | | F14M | F14F | 10 |
| | | RF12210200 | Female elbow fitting | | F13M | F13F | 10 |
| | | RF22220200 | Female elbow fitting | | F14M | F14F | 10 |
| | | RF12310100 | T-fitting | | F13M | F13F | 10 |
| | | RF22320100 | T-fitting | | F14M | F14F | 10 |
| | | RF12310200 | Female T-fitting | | F13M | F13F | 10 |
| | | RF22320200 | Female T-fitting | | F14M | F14F | 10 |
| | | KA00F10001 | TWIN 1 fitting | | F13M | F13F | 10 |
| | | KA00F10002 | TWIN 2 fitting | | F13M | F13F | 10 |

ACCESSORIES AND SPARE PARTS

| Image | Drawing | Code | Description | DN | Pack |
|-------|---------|-------------|---|----|------|
| | - | KA00K40011 | Handle E4 kit | - | 1 |
| | | KA00K00015 | Modular handle E4 extension kit 23mm modular extension + screws + extensions for plate* | - | 1 |
| | | KRTCE415000 | Teco Control E4 spare part kit | 15 | 1 |
| | | KRTCE420000 | Teco Control E4 spare part kit | 20 | 1 |
| | - | KRPL0004 | 150x105x15 mm** Maintenance Frame** | - | 1 |

* Several extension kits can be applied to the same valve

** If the box is installed incorrectly, the maintenance frame is used besides wall-flush

E104 - ELECTRIC MOTOR

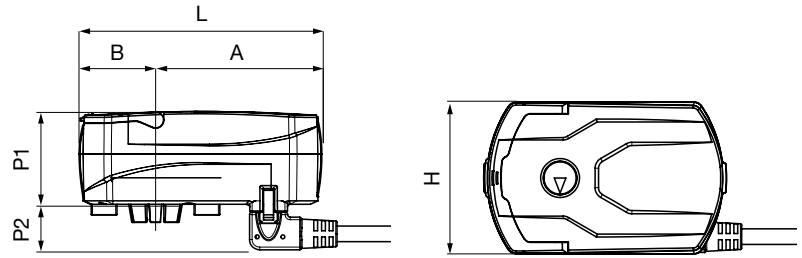

| Appl. | Code | Voltage | Auxiliary microswitch | L | H | P1 | P2 | A | B | Pack |
|-------|-----------------|---------|-----------------------|----|----|----|----|----|----|------|
| | E1045100 | 230V | Switch when closing | 95 | 59 | 36 | 18 | 65 | 30 | 1 |
| | E1046100 | 24V | Switch when closing | 95 | 59 | 36 | 18 | 65 | 30 | 1 |
| | E1042100 | 230V | Switch when opening | 95 | 59 | 36 | 18 | 65 | 30 | 1 |
| | E1044100 | 24V | Switch when opening | 95 | 59 | 36 | 18 | 65 | 30 | 1 |

Includes:

Cable (1 m)

Does not include:

Optional cable (3 m)

Features

- Low energy consumption electric stepper motor.
- Available in 4 different models depending on the usage requirements (domestic water systems or heating / connection to home automation systems or switch actuation).
- Quick assembly and disassembly thanks to the Snap-Fit connection and the Molex Microfit connector.

6P X 3M + CN cable kit. MICROFIT

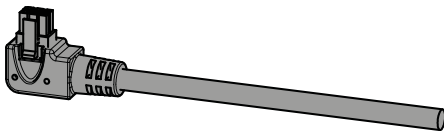

| Code | L | Pack |
|-------------------|-----|------|
| KA00K00014 | 3 m | 1 |

Field of use

- Domestic water systems
- Heating

Safety

| | | |
|----------------------|---|-------------------|
| IP protection rating | 40 | IEC EN 60529/1997 |
| Insulation class | Class II equipment according to IEC 61140 (double insulation with no earth conductor) | |

Operation

| | | |
|---|-------------------------|---|
| Actuation time [s] | 20 | |
| Auxiliary microswitch with 3-wire output (applications) | Maximum current | 6A @ 250Vac for resistive loads |
| 6-pole power cable | Connector | 1 M |
| | Length | Molex Micro-Fit JR 2x3 |
| Operating temperature and humidity | Environment | -30 to 50°C @ 95% without condensation |
| | Fluid | 65°C continuous with peaks of 90°C while respecting the ambient temperature constraints |
| Regulatory compliance | EN 60730-1 | Automatic electric control devices for domestic use and similar |
| | 2014/30/EU EN 61000-6-4 | Electromagnetic compatibility |

Wiring diagram



Specifications:

Electric motor E104

Low consumption silent, compact electric stepper motor, with ON-OFF function and auxiliary microswitch in the version with opening signal (heating) or in the version with safety feedback when the valve has closed (domestic water).

Quick assembly and disassembly thanks to the Snap-Fit connection and the Molex Microfit connector.

Ambient temperature -30/+50°C.

**THERE IS A REMOTE CONTROLLED
EXTERNAL VERSION IN ADDITION TO THE
CONCEALED VERSION**

T4
E-READY

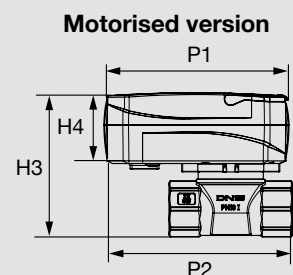
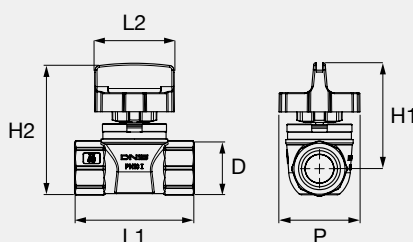
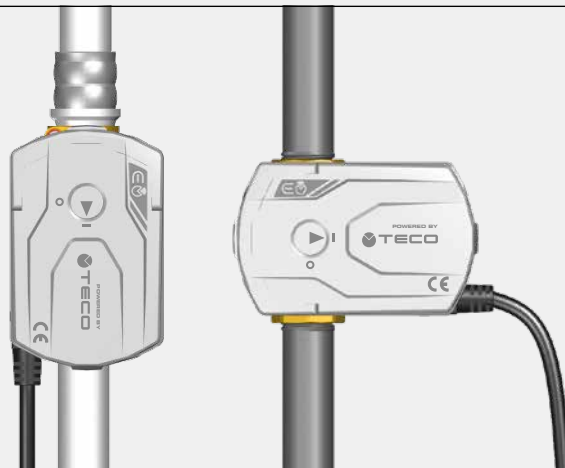

| Code | DN | D | L1 | L2 | H1 | H2 | P | Pack | P1 | P2 | H3 | H4 |
|-------------------|----|---------|----|----|----|----|----|------|----|-----|----|----|
| T4P3271100 | 15 | F13F | 59 | 42 | 54 | 68 | 42 | 5 | 94 | 94 | 73 | 39 |
| T4P4271100 | 20 | F14F | 72 | 42 | 58 | 75 | 42 | 5 | 94 | 100 | 80 | 39 |
| T4P3211100 | 15 | FF 1/2" | 63 | 42 | 54 | 70 | 42 | 5 | 94 | 96 | 73 | 39 |
| T4P4211100 | 20 | FF 3/4" | 72 | 42 | 58 | 75 | 42 | 5 | 94 | 101 | 79 | 39 |

Specifications:

T4 E-READY Shut-off valve motorisable

Top Entry removable ball shut-off valve with full bore, compliant with DIN EN13828.

Technopolymer ball and "soft-turn" anti-blocking gas-gaskets for gentle manoeuvring.

Brass body.

Operating pin compatible with the mounting of the ON-OFF electric motor with auxiliary microswitch in the version with opening signal or in the version with safety feedback when the valve has closed.

Does not include:

Fittings, motor and cable

Features

- Top Entry ball valve, with brass body and Top Entry system® compliant with DIN EN 13828 with light "Soft Turn®" manoeuvring.
- Closing and opening manually with the handle or motorised with the **E104** motor.

Field of use

- For hot and cold drinking water
- Domestic water systems
- Heating

MATERIAL

| | |
|----------------|---------------|
| Body | Brass CW617N |
| Top-Entry Ball | Technopolymer |

TECHNICAL DATA

| | |
|----------------------------|---|
| Connections | FASTEC® |
| Operating pressure | PN10 (10 bar) |
| Temperature | 0 °C + 95 °C |
| Standard and certification | DIN EN 13828 - (KTW-W270) DVGW W 570-1 |

**4 Positions
of the E104 motor**

