

FASTEC®

SIMPLE AND SECURE PLUMBING CONNECTION

NEW

SIMPLIFIES DIFFICULT INSTALLATIONS



 **TECO®**
INNOVATING SAFETY

Multiple materials
Multiple diameters
Multiple systems

Wide range of
valves

Quick, safe, reliable
connection both external
and chased

Wide range of
adapters and fittings

Multi-directional
360° rotatable

FASTEC®

SIMPLIFIES DIFFICULT INSTALLATIONS

A range of solutions for renovations, repairs and new installations with difficult or unforeseen connections.

FEATURES

- Quick and safe connection without tools.
- Unbeatable in tight spaces.
- Sealing ensured by O-RING with static (controlled) predefined compression.
- Reliability certified by millions of fittings installed worldwide, both external and chased.
- Wide range of fittings, adapters and valves to suit many system solutions.
- Rotatable.
- Non-extractable pin with pressurised system.

APPLICATIONS

- For hot and cold drinking water
- For cooling and heating water with or without antifreeze
- For external and chased installations

TECHNICAL DATA

Max. operating pressure
of the connection: 16 bar

Temperature: -30 °C / +95 °C

Certification: DIN DVGW EN 13828

Material certification: KTW-BWGL



SIMPLE AND SECURE CONNECTION

Only two steps are needed for a secure connection: engaging the fitting and lowering the pin.
The pin is integrated into the fitting and gives visual, tactile and acoustic feedback, guaranteeing a perfect connection when activated.

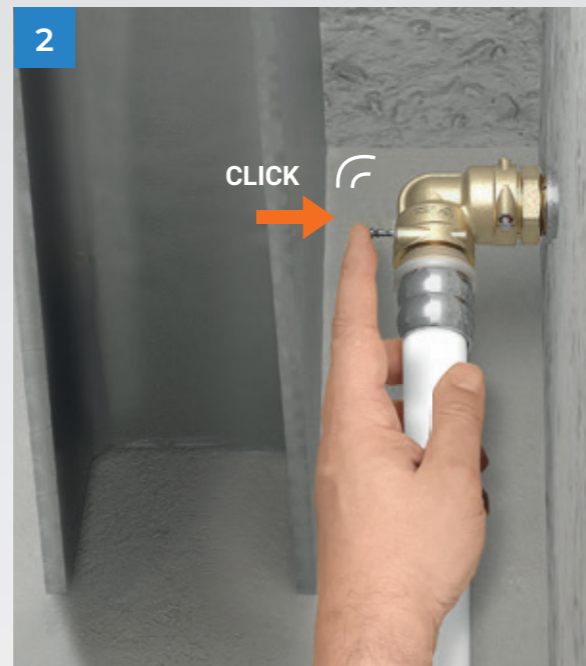
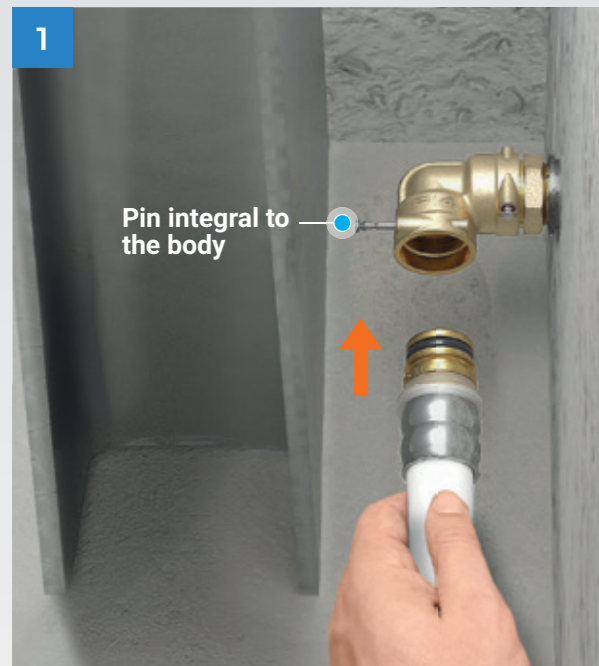

1 Insert the connector.
The fastening pin integral with the valve or fitting body makes connection extremely easy and convenient.

2 The connection is sealed with a CLICK
The pin can only be lowered if the fitting has been inserted correctly.



VISUAL FEEDBACK
The pin closes when fully inserted.



TACTILE FEEDBACK
The pin gives tactile feedback at the end of its travel.



ACOUSTIC FEEDBACK
A click confirms successful connection.

PERFECT SEAL

Fastec ensures that the plumbing connection is made precisely, thus avoiding unintended mechanical stress on the joint.

An O-ring with predefined compression guarantees a perfect long-term seal, for a totally secure connection.

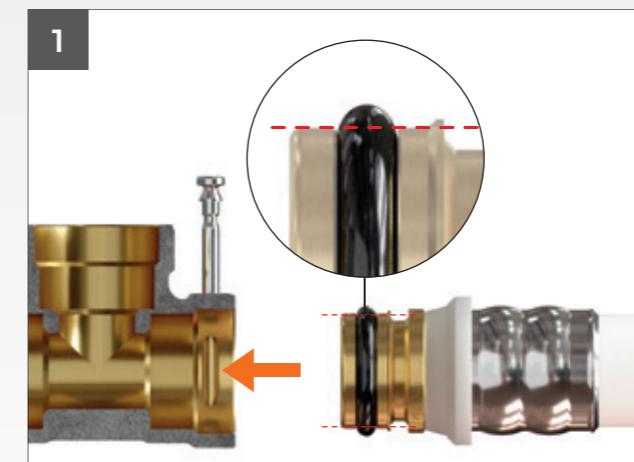
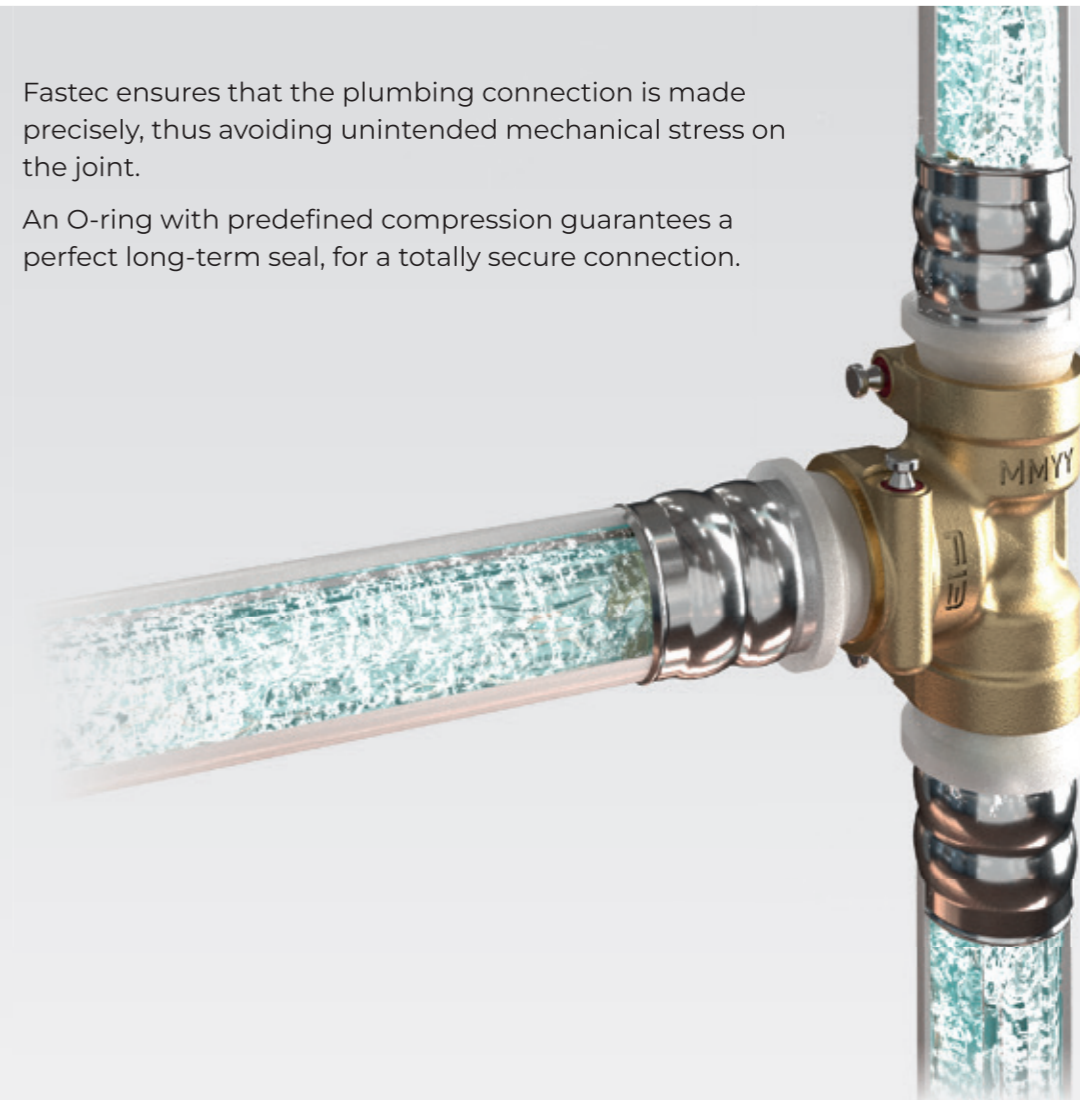

1 The O-RING is made of peroxide EPDM and is housed in a seat that allows it to adapt during insertion.

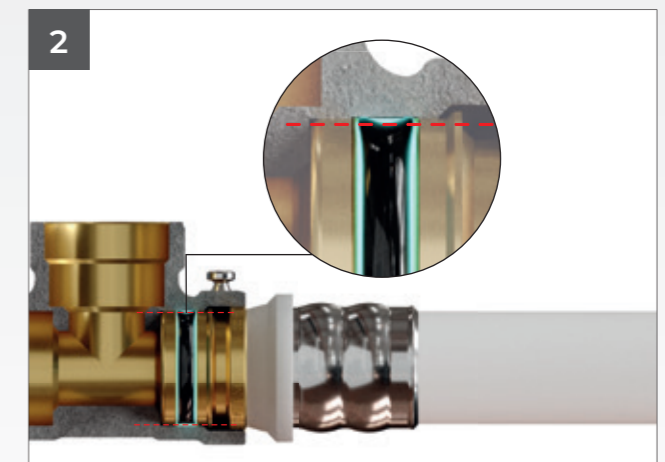

2 The static compression of the O-RING guarantees a perfect seal between the fitting and valve. The predefined compression is not a source of stress for the O-RING.

SIMPLIFIES DIFFICULT INSTALLATIONS

Multi-directional 360° rotatable

The Fastec connection system further simplifies installation by allowing valves and adapters to be rotated through 360°.

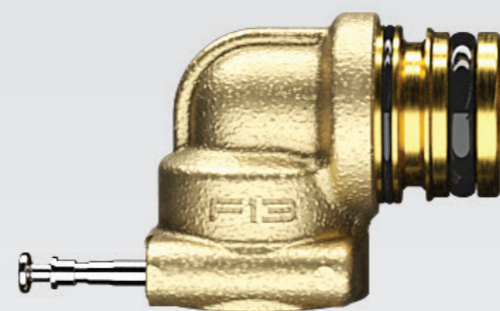
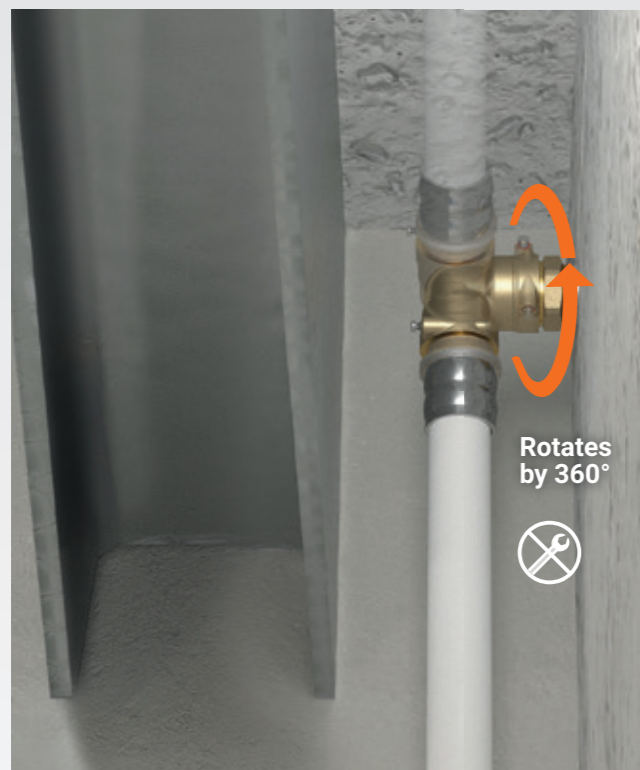

THE FITTING IS ROTATABLE

Valves with the Fastec connection system, as well as all available adapters, can easily rotate through 360°.

This facilitates optimal connection positioning and installation, especially in tight spaces or when working near walls or barriers.

EXTENDER FASTEC connect the impossible

NEWS

Do you need to connect two secured points of the system, perhaps made from different materials or in different sizes?
Complete or repair your system quickly and easily with Fastec Extenders.

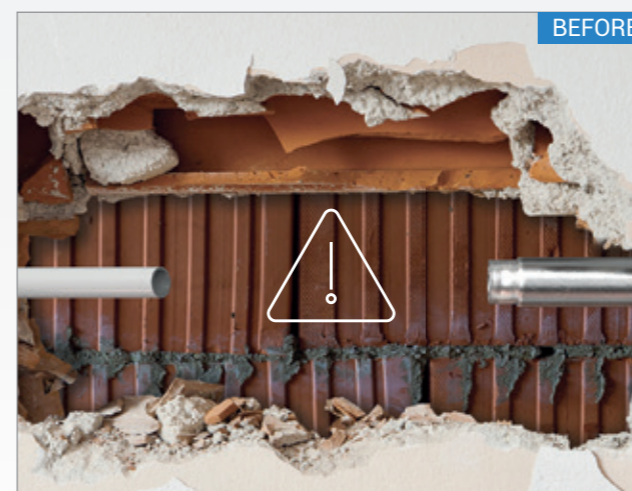
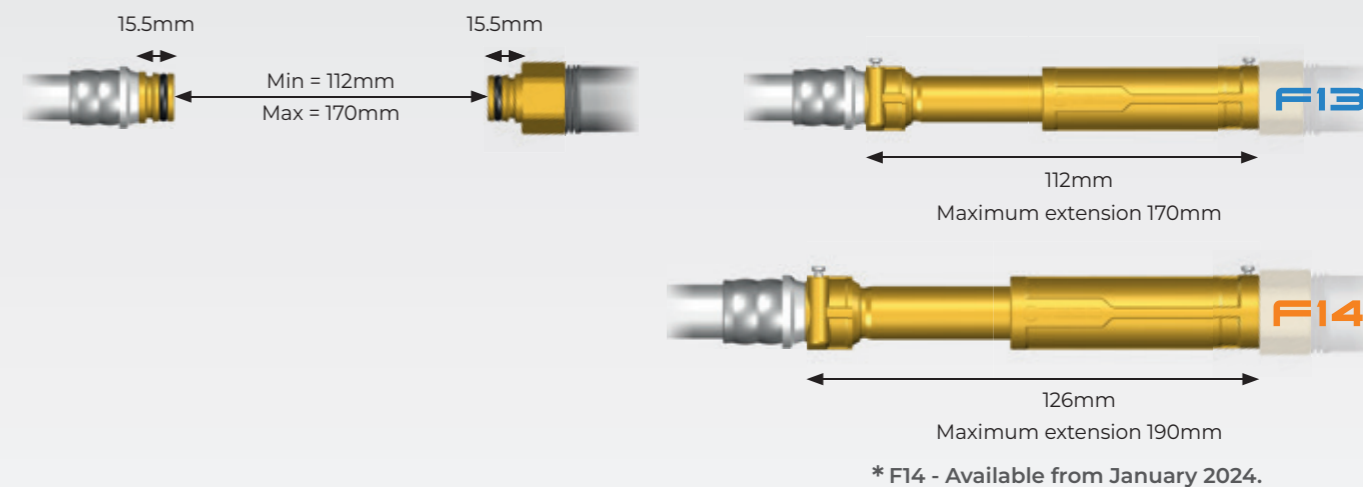

WIDE RANGE OF ADAPTERS AND FITTINGS



Multiple materials, Multiple systems and Multiple diameters

UNLIMITED POSSIBILITIES

Fastec responds in a practical and versatile manner to different installation requirements.

CHOOSE THE RIGHT MATERIAL FOR A PERFECT SYSTEM

- Copper
- Steel
- Multi-layer composite
- PP-R
- PEX

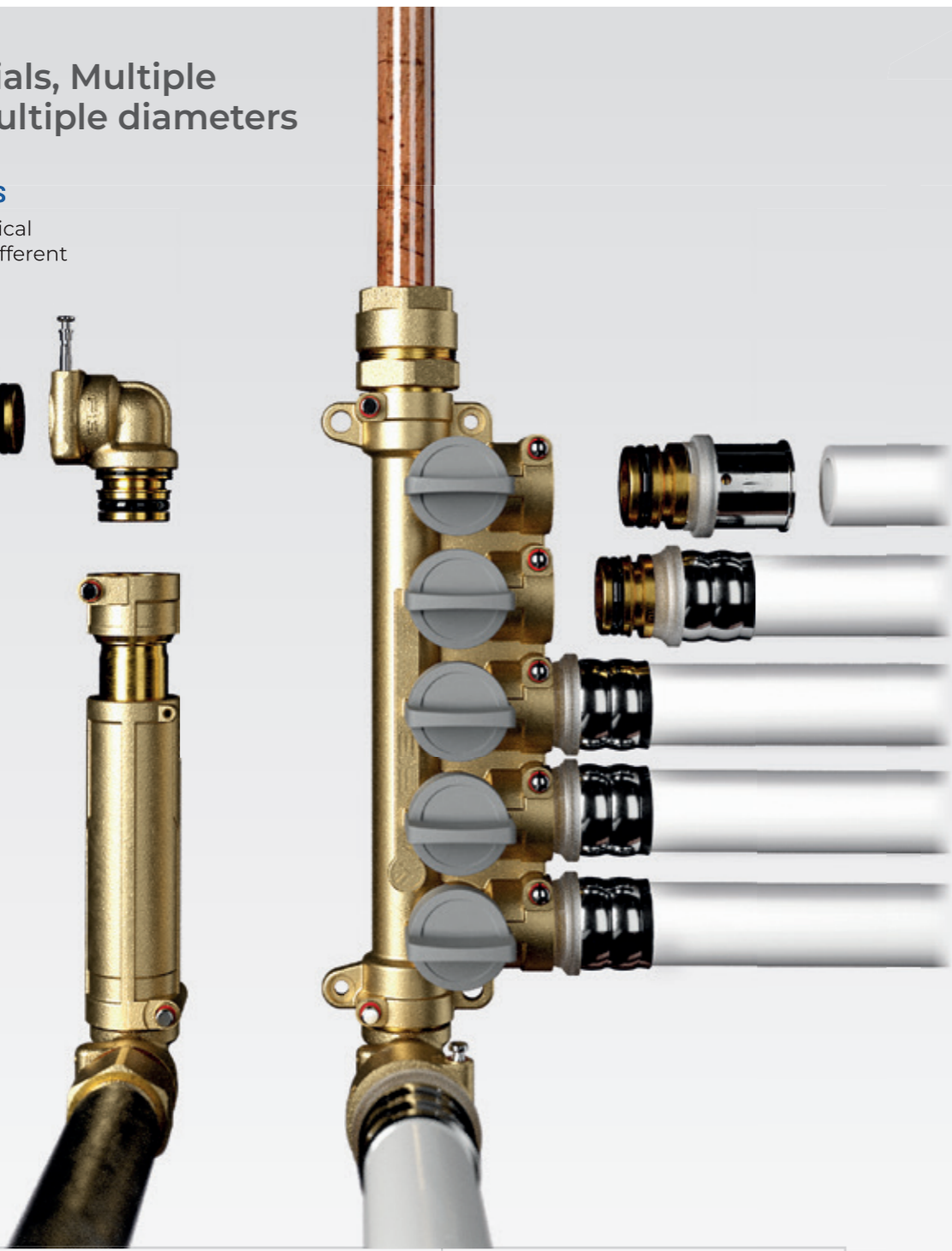

Fastec adapter and fitting range

FASTEC ADAPTERS

Thanks to the available fittings, pipes with different diameters and made of different materials can be connected easily and efficiently.



THREADED FITTINGS



RANGE OF ORIGINAL FITTINGS FROM DOMESTIC WATER SYSTEM MANUFACTURERS

The Fastec connection can be used with the main multilayer or PEX pipe systems on the market, thanks to the availability of numerous original fittings from manufacturers.



HOW TO CHOOSE FASTEC?

The table shows the correspondence between Fastec connections and commonly used diameters.

FASTEC®	TRADITIONAL CONNECTIONS		
	DN	INCHES	MULTILAYER / PEX PIPE
F13	15	1/2"	Ø 12 - 16 - 20 - 25 - 26
F14	20	3/4"	Ø 26 - 32

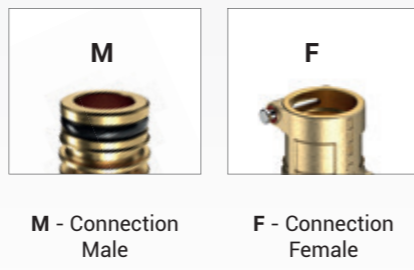

FASTEC THE SOLUTION FOR EVERY NEED

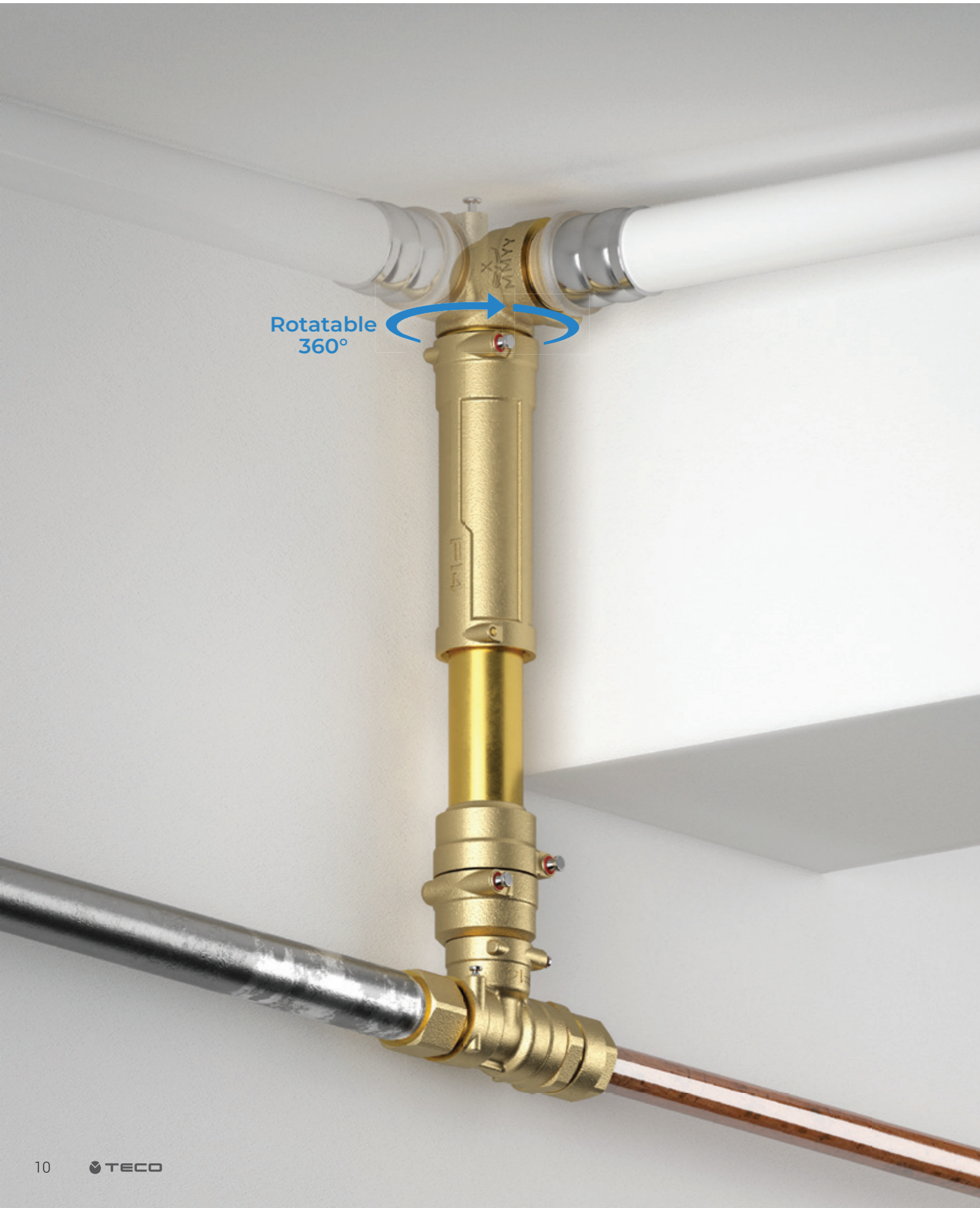

TECO Fastec Starter Kit

MCC0230

ALWAYS HAVE THE IDEAL SOLUTION WITH YOU

Make sure you always have your Fastec adapter and connector case with you to solve many situations quickly and easily without having to go to the warehouse.

Fill the case with the adaptors that you require.

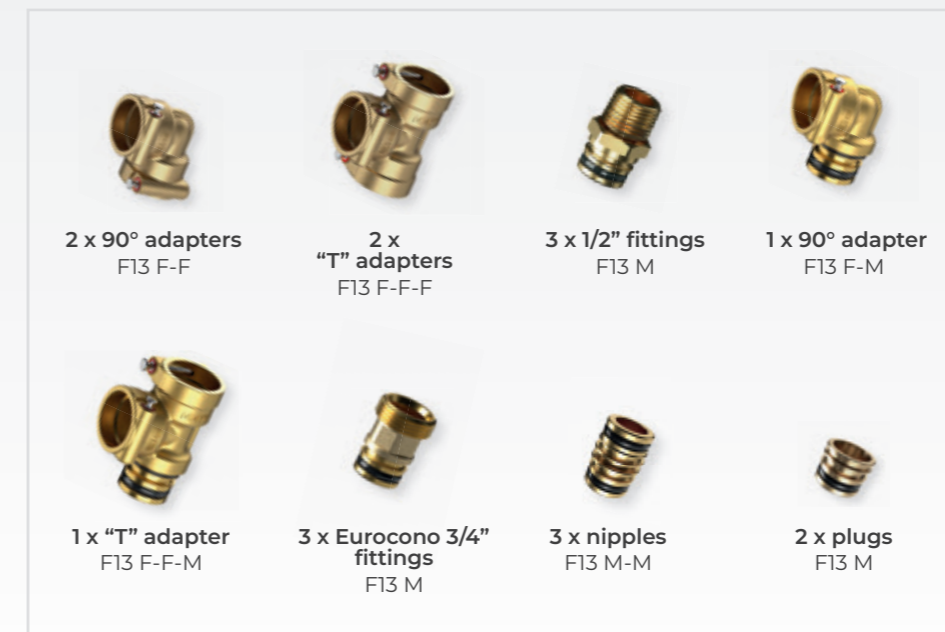

FASTEC STORE



HOW TO CHOOSE FASTEC?

The table shows the correspondence between Fastec connections and commonly used diameters.

TRADITIONAL CONNECTIONS			
FASTEC®	DN	INCHES	MULTILAYER / PEX PIPE
F13	15	1/2"	Ø 12 - 16 - 20 - 25 - 26
F14	20	3/4"	Ø 26 - 32

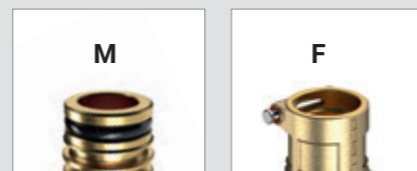

M - Connection Male

F - Connection Female

F13 F14 Adapters

Code	Description	Pack
RF12210200	F13 90° F / F	10
RF22220200	F14 90° F / F	10
RF12210100	F13 90° M / F	10
RF22220100	F14 90° M / F	10
RF12310200	F13 T F / F / F	5
RF22320200	F14 T F / F / F	5
RF12310100	F13 T M / F / F	5
RF22320100	F14 T M / F / F	5
RF12110200	F13 Nipple F / F	10
RF22120100	F14 Nipple F / F	10
KA00K00008	F13 Nipple M / M	10
KA00K00017	F14 Nipple M / M	10
KA00F10001	Dual joint F13 Twin F / F / M	5
KA00K00016	F13 Plug F	10
KA00K00018	F14 Plug F	10
KA00K00002	F13 Plug M	20
KA00K00010	F14 Plug M	10
RF12101100	Reducer from F14 F → F13 M	10

F13 F14 EXTENDER telescopic joint

Code	Description	Pack
RF12110300	Telescopic joint EXTENDER F13 F / F L 112 - MAX 170 mm	10
RF22120200	Telescopic joint EXTENDER F14 F / F L 126 - MAX 190 mm (available from January 2024)	10

F13 F14 Threaded fittings

Code	Description	Pack
KA00K00003	F13 M x 1/2" M	10
KA00K00013	F13 M x 3/4" M	10
KA00K00009	F14 M x 3/4" M	10
KA00K00019	F14 M x 1" M	10
RF12101000	F13 M x 1/2" F	10
RF12111000	F13 M x 3/4" F	10
RF12120100	F14 M x 3/4" F	10
RF12120200	F14 M x 1" F	10
KA00K00004	F13 M x EK 3/4" F	10
RF122F0100	F13 90° M x 1/2" M	10
RF122F0200	F13 90° M x 1/2" F	10
RF12110900	Swivel nut F13 M x G 3/4"	10

F13 F14 Valves

Code	Description	Pack
T4P32C1100	F13 T F / F / F	10
T4P32C2100	F13 T F / M / F	10
T4P32C3100	F13 T M / F / F	10
T4P3271100	F13 Straight F / F	10
T4P4271100	F14 Straight F / F	10
T4P3272100	F13 Straight F / M	10

F13 Fittings for PEX pipes

Code	PIPE Ø x Thickness	Pack
RF12100100	F13 16 x 1.8	10
RF12100200	F13 20 x 1.5	10
RF12100300	F13 25 x 2.3	5
RF13M1210301	F13 12 x 1.1	10
RF13M1610301	F13 16 x 1.5	10
RF13M2010301	F13 20 x 1.9	10
RF13M1210401	F13 12 x 1.1	10
RF13M1610401	F13 16 x 1.5	10
RF13M2010401	F13 20 x 1.9	10

F13 Fastec case

	Ready-to-use case
	MCC0230
	Empty case code
	MCC0240

F13 F14 Fittings for multi-layer pipes

Code	PIPE Ø x Thickness	Pack
RF13M16101VA	F13 16 x 2.0	10
RF13M16102VA	F13 16 x 2.25	10
RF13M20101VA	F13 20 x 2.0	10
RF13M20102VA	F13 20 x 2.5	10
RF13M26101VA	F13 26 x 3.0	5
RF14M26101VA	F14 26 x 3.0	5
RF14M32101VA	F14 32 x 3.0	5
511115MP	F13 16 x 2.0	5
511116MP	F13 16 x 2.25	5
511118MP	F13 20 x 2.0	5
511119MP	F13 20 x 2.25	5
511120MP	F13 20 x 2.5	5
511121MP	F13 25 x 2.5	5
511122MP	F13 26 x 3.0	5
1651039	F13 16 x 2.0	10
1651040	F13 20 x 2.0	10
1651041	F13 26 x 3.0	5
39342	F13 16 x 2.0	10
39344	F13 20 x 2.0	10

F13 Fittings with Fastec connection for multi-layer pipes available from manufacturers

Pipe Ø 16-20	Pipe Ø 16-20-26	Pipe Ø 16-20-26
+GF+		TECE:
Pipe Ø 16-20	Pipe Ø 16-20	Pipe Ø 20
Pipe Ø 16-20-25		

CONNECT WITH THE TECO RANGE



F13 Meter kit

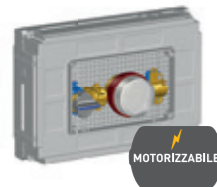

K4CC MONO

flush-mounting metering kit with single volumetric meter



Kit code	DN	Connections	
		FASTEC®	
K4CCDF10100	DN15	F13	

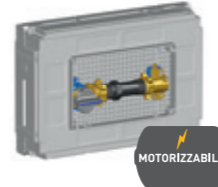

K4CC MONO

flush-mounting metering kit with 80 mm flushing pipe without meter



Kit code	DN	Connections	
		FASTEC®	
K4CCDF10200	DN15	F13	

F13 F14 Shut-off and valve units



K4.0

unit with dual flush-mounting shut-off

Kit code	DN	Connections	
		FASTEC®	
K400BF10100	DN15	F13	
K400BF30100	DN20	F14	
K400BF50100	DN15 DN20	F13	F14

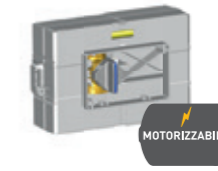

K4.1

unit with single shut-off and valve with optional motor



Kit code	DN	Connections	
		FASTEC®	
K401BF10300	DN15	F13	
K401BF30200	DN20	F14	

F13 Manifold kits



K4.3

flush-mounting multiple shut-off manifold kit 4+3 and 5+4 outlets

Kit code	DN	Connections	
		FASTEC®	
K403DF10200	4+3 DN10	F13	
K403DF10100	5+4 DN10	F13	

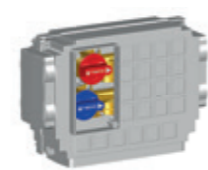

K4.2

manifold kit with flush-mounting main shut-off

Kit code	DN	Connections	
		FASTEC®	
K402BF10100	DN15	F13	

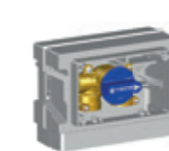

K4.1

unit with single shut-off and "U" inlet and outlet

Kit code	DN	Connections	
		FASTEC®	
K401BF10100	DN15	F13	

F13 Manifolds



CK

Multiple shut-off manifold

Kit code	DN	Connections	
		FASTEC®	
CK034F10100	DN15	F13	x 4
CK035F10100	DN20	F13	x 5



ULTRA

Flush-mounting Top Entry valve straight version

Kit code	DN	Connections	
		FASTEC®	
U4P3971100	DN15	F13	
U4P4971100	DN20	F14	



ULTRA

Flush-mounting Top Entry valve "U" version

Kit code	DN	Connections	
		FASTEC®	
U4P3972100	DN15	F13	



Via Sandro Pertini no. 39/41
25050 Provaglio d'Iseo (BS), Italy
Tel. +39 030 6850510 | +39 030 6850555

info@tecosrl.it - www.tecosrl.it

 made in Italy since 1987

