



## G4 - G4F

### VALVES FOR GAS SYSTEMS WITH THERMAL SAFETY DEVICE



#### G4

Shut-off valve with Firebag® thermal safety device  
DN15 - DN50 threaded version

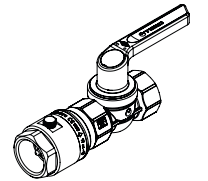

207

#### G4F

Shut-off valve with Firebag® thermal safety device  
DN25 - DN150 flanged version

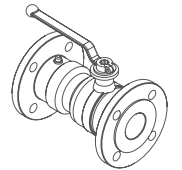

210

# G4

## SHUT-OFF VALVE WITH THERMAL SAFETY DEVICE

THREADED VERSION

### FULL RANGE:

Threaded version from DN15 (1/2") to DN50 (2").

## FIREBAG® - TAE

G4 valves have a FIREBAG® thermal safety device built into the steel inlet fitting. FIREBAG® complies with the requirements of the DIN 3586 standard and activates at a temperature of 100 °C - 5K and withstands up to 925 °C for 60 minutes at a pressure of 5 bar (see page 231)



### CERTIFICATIONS AND TECHNICAL SPECIFICATIONS

Reference standards	DIN EN 331 DIN 3586
Working pressure	MOP 5 (5 bar)
Working temperature	-20 °C +60 °C
High temperature resistance	HTB 650 °C for 30' [DIN EN331 C5]
FIREBAG® trip temperature	100 °C - 5K
Application	For all types of gas as specified in EN 437 and DWG G260/1 (Methane, Butane, Propane)



### INSTALLATION AND APPLICATION EXAMPLES

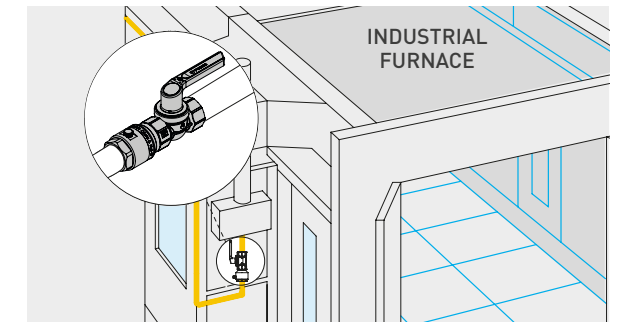
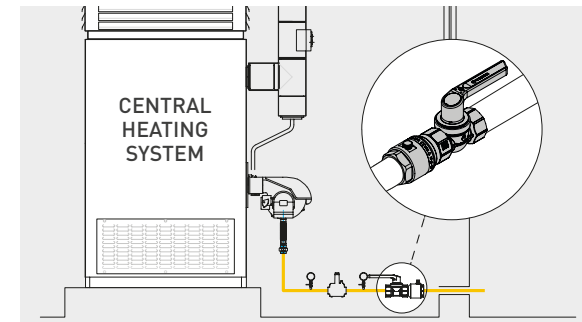

### G4 PRESSURE DROP

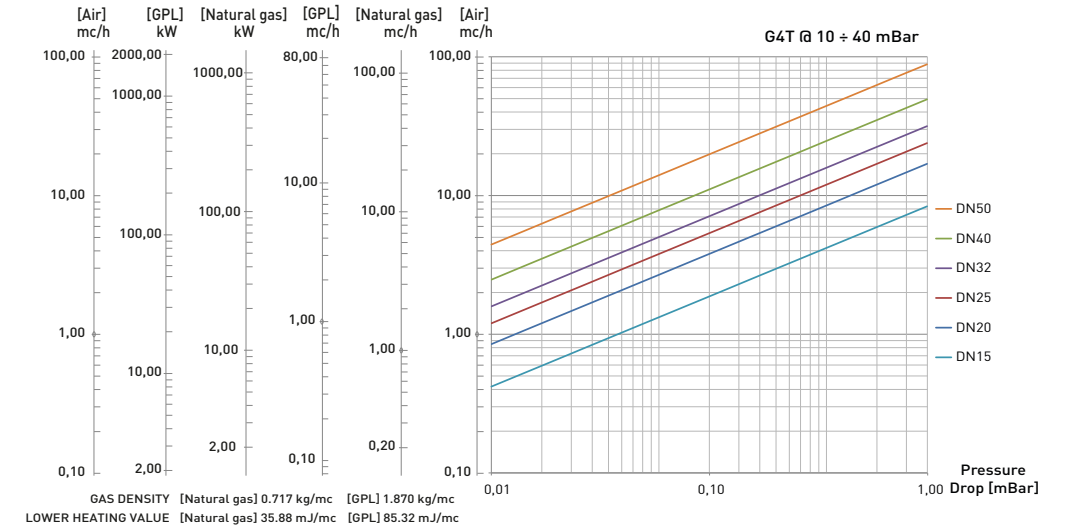

### G4 THREADED SHUT-OFF VALVE WITH FIREBAG® THERMAL SAFETY DEVICE

#### STRAIGHT VALVE - THREADED F/F VERSION DN15 / DN20 / DN25

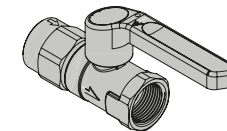

- MOP 5
- -20 °C +60 °C
- HTB 650 °C per 30' [DIN EN 331 C5]

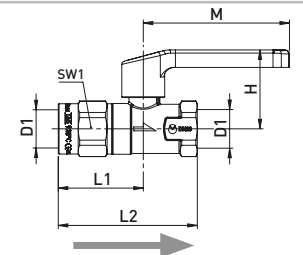

Code	DN	FIREBAG® TAE	D1	L1	L2	H	M	SW	Pack
G221010100	15	•	Rp1/2"	46	75	58	46	27	15
G222010100	20	•	Rp3/4"	53	86	61	49	32	10
G223010100	25	•	Rp1"	68	105	71	52	41	5

#### STRAIGHT VALVE - THREADED F/F VERSION DN32 / DN40 / DN50

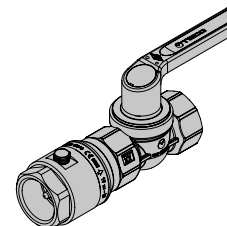

- MOP 5
- -20 °C +60 °C
- HTB 650 °C per 30' [DIN EN 331 C5]

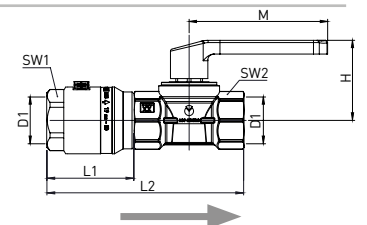

Code	DN	FIREBAG® TAE	D1	L1	L2	H	M	SW1	SW2	Pack
G424010100	32	•	Rp1"1/4	78	177	72	124	50	50	5
G425010100	40	•	Rp1"1/2	78	185	76	124	60	55	5
G426010100	50	•	Rp2"	92	218	86	147	70	69	5