

T4 - T4J - T4 PUNTO BLU

TOP ENTRY BALL SHUT-OFF VALVES

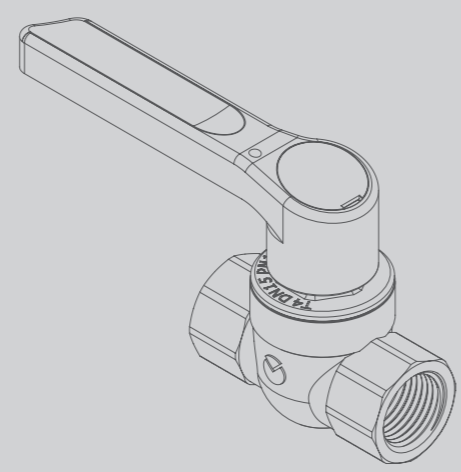

T4
DN15-DN50 universal Top Entry valve

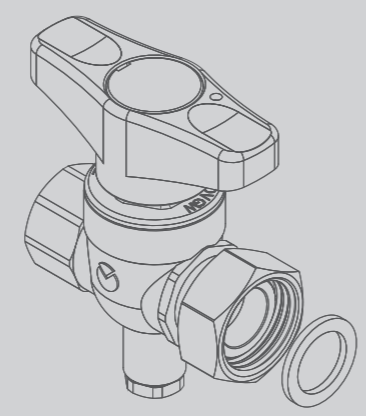
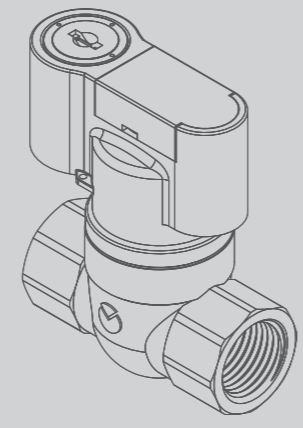
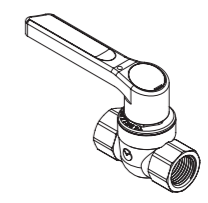

71

T4J
Top Entry valve for metering systems

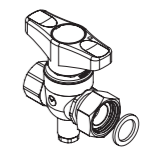

74

T4 PUNTO BLU®
Shut-off valve with lock for low flow rate supply

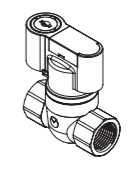

78

T4

TOP ENTRY BALL SHUT-OFF VALVES



HIGH PERFORMANCE

Full flow.

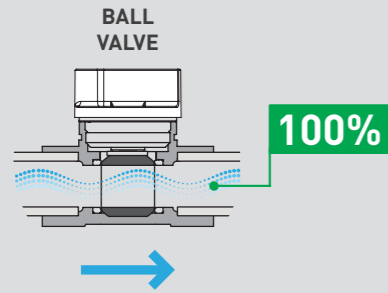

SINGLE-PIECE BODY

The single-piece body makes T4 very strong, which is very important as it is the only element secured to the pipes.

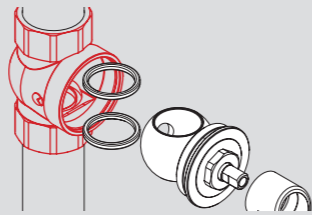

CERTIFIED

Installations for drinking water must be made to the highest standards to prevent trapping water, which could promote the development of microbe colonies (e.g. legionella). T4 valves were developed with build characteristics that prevent water from being trapped (DVGW W570-1).



CERTIFICATIONS AND TECHNICAL SPECIFICATIONS

Reference standards	DIN EN 13828 (PN10) DVGW W 570-1
Working pressure	PN40 (40 bar)
Temperature	0°C +150 °C
Body material	CW617 Brass
Ball material	CW617 chrome plated brass
Control material	AL EN-AB44100 aluminium
Application	Water, heating, pneumatic, petrochemical and oil distribution systems. Suitable for non-aggressive fluids and vacuum.



TOP-ENTRY

The Top Entry system ensures that the ball can be fully removed. Spare parts availability is guaranteed for more than 30 years.



INSTALLATIONS AND APPLICATIONS

Water, heating, pneumatic, hydraulic and petrochemical distribution systems. T4 is suitable for non-aggressive fluids and vacuum systems.

Temperature / Pressure

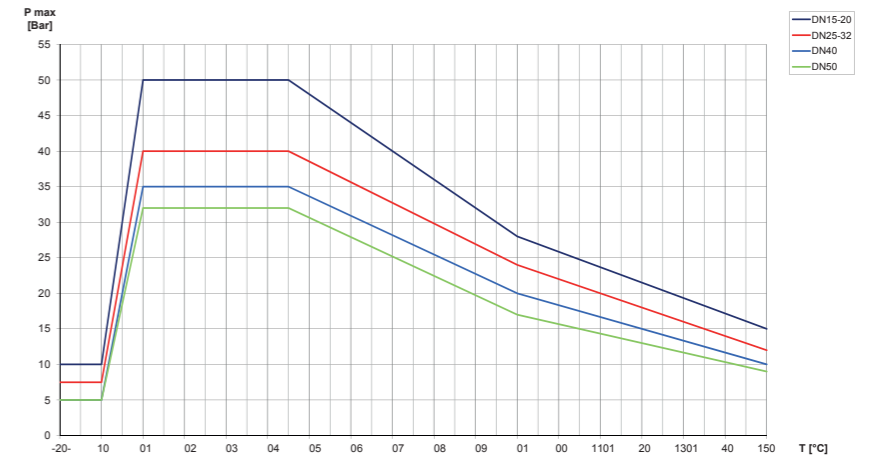

T4 "TOP ENTRY" THREADED SHUT-OFF VALVE

VALVE - STRAIGHT THREADED F/F VERSION

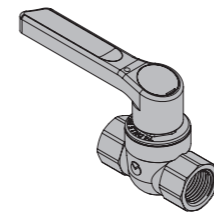

- Control lever
- PN40 (40 bar)
- 0-150 °C

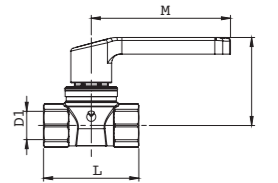

Code	DN	D1 EN-10226-1	L	H	M	SW	Pack
T4040300	15	Rp1/2"	63	58	92	27	50
T4040400	20	Rp3/4"	73	61	92	32	40
T4040500	25	Rp1"	83	71	124	41	20
T4040600	32	Rp1"1/4	100	76	124	50	15
T4040700	40	Rp1"1/2	110	82	147	55	10
T4040800	50	Rp2"	131	88	147	70	5

VALVE - STRAIGHT THREADED F/F VERSION

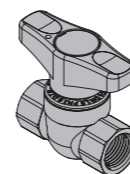

- Control handle
- PN40 (40 bar)
- 0-150 °C

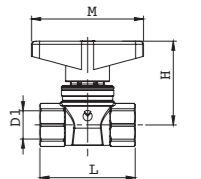

Code	DN	D1 EN-10226-1	L	H	M	SW	Pack
T4041300	15	Rp1/2"	63	55	74	27	50
T4041400	20	Rp3/4"	73	58	74	32	40

T4J

TOP ENTRY BALL SHUT-OFF VALVES FOR METERING SYSTEMS



HIGH PERFORMANCE

Full flow.

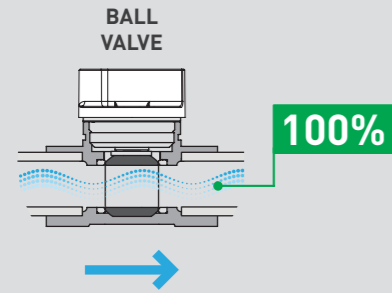

CERTIFIED

Installations for drinking water must be made to the highest standards to prevent trapping water, which could promote the development of microbe colonies (e.g. legionella). T4J valves were developed with build characteristics that prevent water from being trapped (DVGW W570-1).



CERTIFICATIONS AND TECHNICAL SPECIFICATIONS

Reference standards	DIN EN 13828 (PN10) DVGW W 570-1
Working pressure	PN40 (40 bar)
Temperature	0°C +150 °C
Body material	CW617 Brass
Ball material	CW617 chrome plated brass
Control material	AL EN-AB44100 aluminium
Application	Water, heating, pneumatic, petrochemical and oil distribution systems. Suitable for non-aggressive fluids and vacuum.

SINGLE-PIECE BODY

The single-piece body makes T4J very strong, which is very important as it is the only element secured to the pipes.

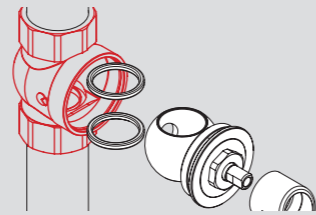

TOP-ENTRY

The Top Entry system ensures that the ball can be fully removed. Spare parts availability is guaranteed for more than 30 years.



INSTALLATIONS AND APPLICATIONS

Metering systems

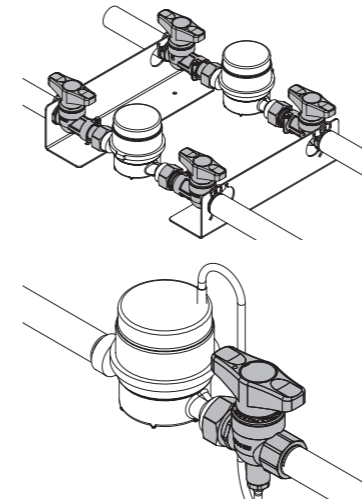

Temperature / Pressure

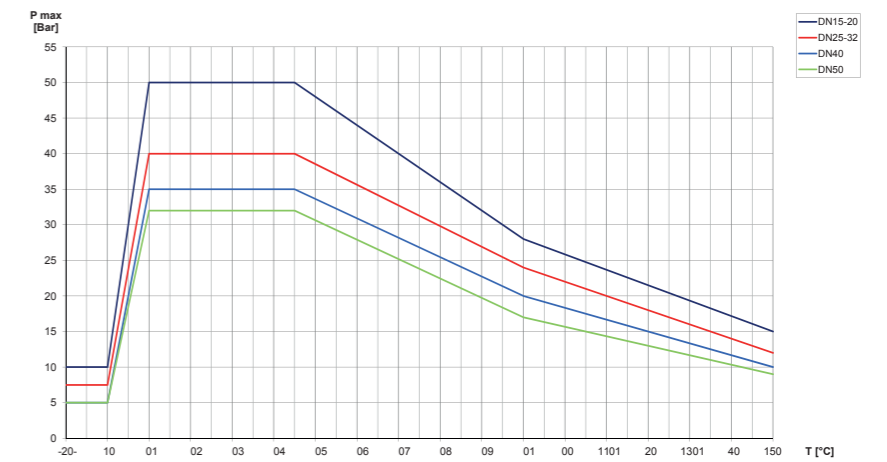

T4J "TOP ENTRY" VALVE FOR METERING SYSTEMS

VALVE WITH PROBE FITTING - THREADED F/F VERSION

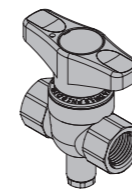

- Control handle
- PN40 (40 bar)
- 0-150 °C

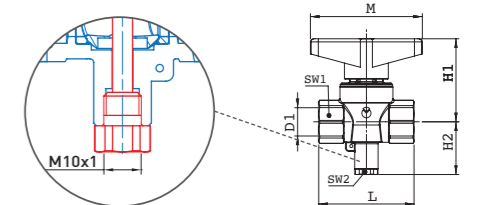

Code	DN	D1 EN-10226-1	L	H1	H2	M	SW1	SW2	Pack
T40413J0	15	Rp1/2"	63	55	32.5	74	27	14	45
T40414J0	20	Rp3/4"	73	58	32.5	74	32	14	35
T40415J0	25	Rp1"	73	88	35	94	41	14	20

VALVE WITH PROBE FITTING - THREADED F/F VERSION

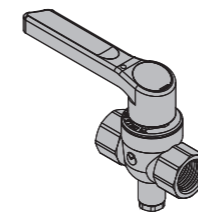

- Control lever
- PN40 (40 bar)
- 0-150 °C

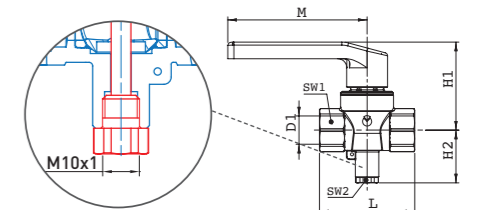

Code	DN	D1 EN-10226-1	L	H1	H2	M	SW1	SW2	Pack
T40406J0	32	Rp1"1/4	100	76	37.5	124	50	14	15
T40407J0	40	Rp1"1/2	110	82	41	147	55	14	10
T40408J0	50	Rp2"	131	88	48.4	147	70	14	5

T4J "TOP ENTRY" VALVE FOR METERING SYSTEMS

STRAIGHT VALVE WITH PROBE FITTING – THREADED/SWIVEL NUT VERSION

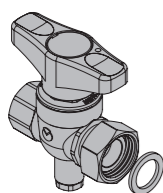

- Control handle
- PN40 (40 bar)
- 0-150 °C

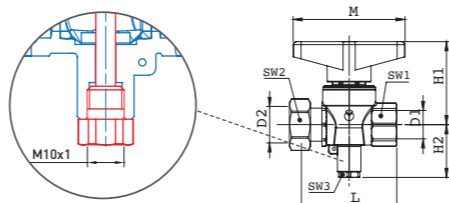

Code	DN	D1 EN-10226-1	D2 EN-228-1	L	H1	H2	M	SW1	SW2	SW3	Pack
T40413J0R	15	Rp1/2"	G3/4"	71	55	32.5	74	27	30	14	45
T40414J0R	20	Rp3/4"	G1"	73	58	32.5	74	32	37	14	35

STRAIGHT VALVE – THREADED / SWIVEL NUT VERSION

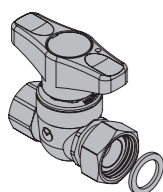

- Control handle
- PN40 (40 bar)
- 0-150 °C

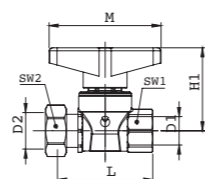

Code	DN	D1	D2	L	H1	M	SW1	SW2	Pack
T4041300R	15	Rp1/2"	G3/4"	82.5	55	74	27	30	45
T4041400R	20	Rp3/4"	G1"	84	58	74	32	37	35

STRAIGHT VALVE – MX THREADED (ISO 228) / SWIVEL NUT VERSION

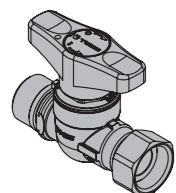

- Control handle
- PN40 (40 bar)
- 0-150 °C

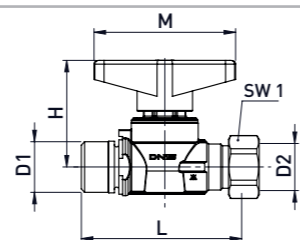

Code	DN	D1	D2	M	L	H	SW1	Pack
T403910400	15	Rp1/2"	G3/4"	74	84	55	30	10

STRAIGHT VALVE WITH EXTENDER – MX THREADED (ISO 228) / SWIVEL NUT VERSION

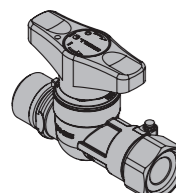

- Control handle
- PN40 (40 bar)
- 0-150 °C

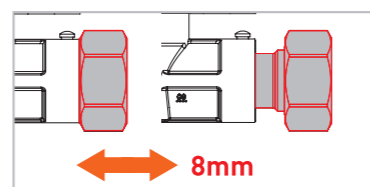

i The FASTEC EX system allows an extension of 8 mm making it easier to connect the metering units.

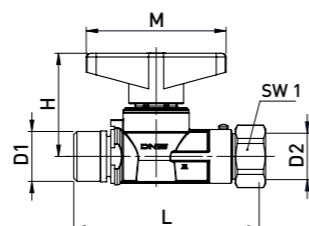

Code	DN	D1	D2	M	L	H	SW1	Pack
T403910200	15	Rp1/2"	G3/4"	74	98+8*	55	30	10

T4 - T4J SPARE PARTS

TECO CONTROL

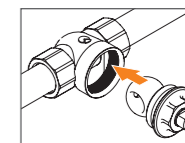
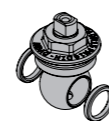

Code	DN	Pack
KRLE040100	15	20
KRLE040200	20	15
KRLE040300	25	10
KRLE040400	32	5
KRLE040500	40	5
KRLE040600	50	2

LEVER

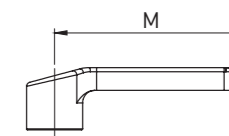
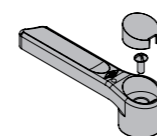

Code	DN	M	Pack
KRLE041100	15-20	92	20
KRLE041200	25-32	124	20
KRLE041300	40-50	147	10

HANDLE

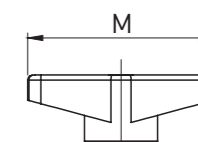
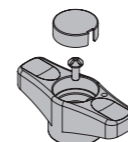

Code	DN	M	Pack
KRMN041100	15-20	74	20
KRMN040300	25	94	10

SEAL KIT



Code	DN	Pack
5004000130	15	20
5004000140	20	15
5004000150	25	10
5004000160	32	10
5004000170	40	10
5004000180	50	10

SHUT-OFF VALVE WITH LOCK FOR LOW FLOW RATE SUPPLY

VIDEO



HIGH PERFORMANCE



Full flow.

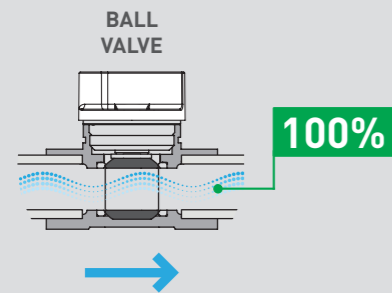

SOFT TURN



Shut-off valve, 90° closure with anti-jamming engineered polymer ball.

PUNTO BLU



Handle with security lock for minimum supply.



CERTIFICATIONS AND TECHNICAL SPECIFICATIONS

Reference standards	DIN EN 13828 DVGW W 570-1
Working pressure	PN10 (10 bar)
Temperature	0°C + 95 °C
Body material	CW617 Brass
Ball material	Engineered polymer
Control material	Nylon PA6
Application	Water, heating, pneumatic, petrochemical and oil distribution systems. Suitable for non-aggressive fluids and vacuum.

CERTIFIED

Installations for drinking water must be made to the highest standards to prevent trapping water, which could promote the development of microbe colonies (e.g. legionella). PUNTO BLU valves were developed with build characteristics that prevent water from being trapped (DVGW W570-1).



OPERATION

The technical characteristics of PUNTO BLU valves allow them to have a double function.

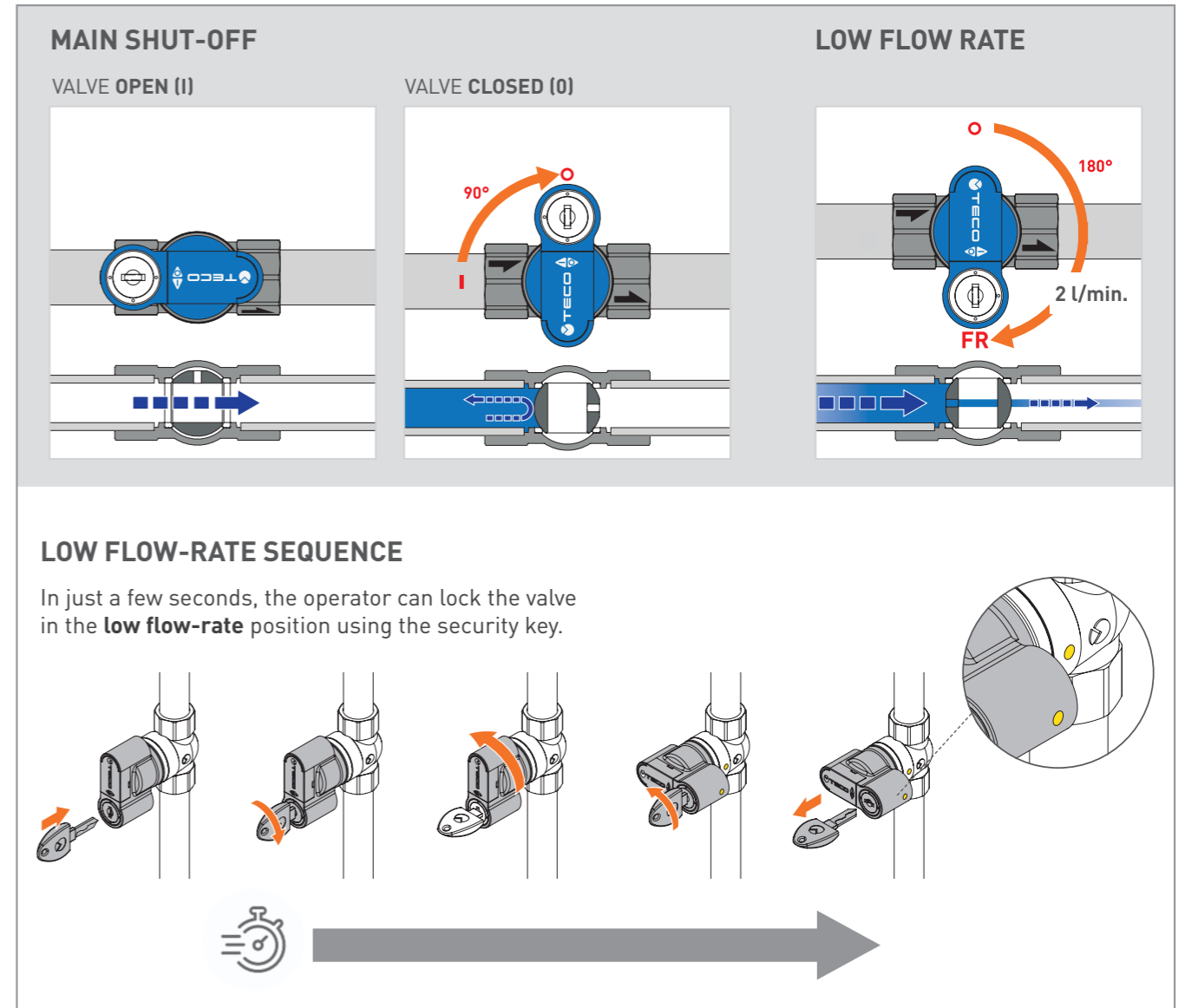

FLOW-RATE GUARANTEED WITH FLOW REDUCTION

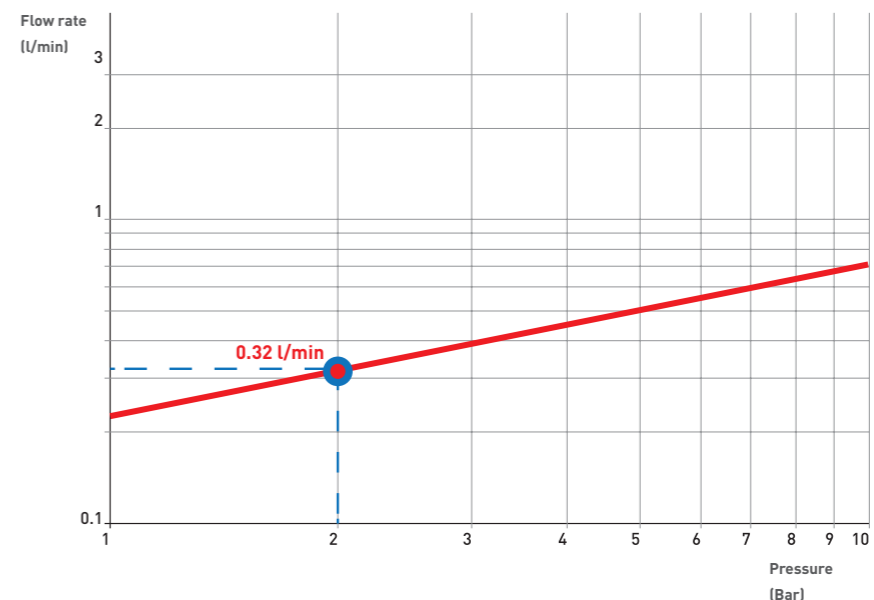

USE AND APPLICATIONS

Why do we recommend using the “PUNTO BLU®” shut-off valve with lock for minimum water supply?

The PUNTO BLU valve is the only instrument that lets you intervene quickly in the event of late payment, with the following benefits:

- block delivery while guaranteeing the minimum flow rate;
- limit the costs of intervening to suspend and restore delivery.

Use of the PUNTO BLU valve is supported by a huge amount of related literature, so the question of late payment is governed in accordance with the citizen's right to use water, since it is common property.

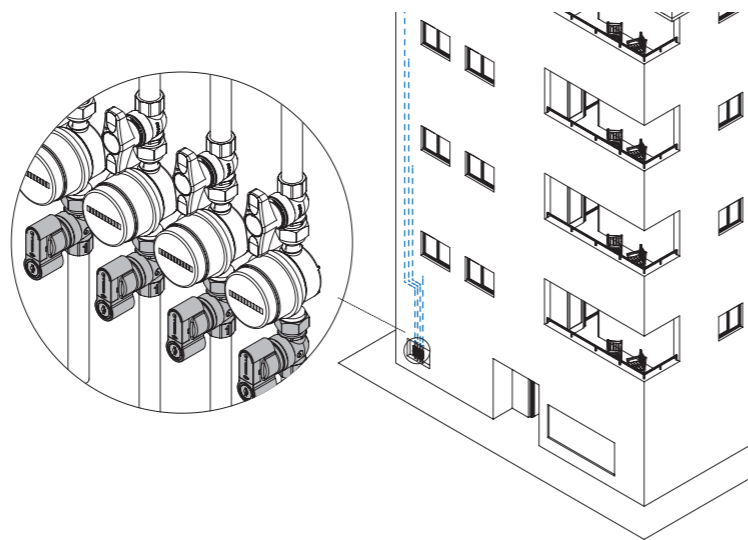

T4 PUNTO BLU SHUT-OFF VALVE WITH LOCK FOR LOW FLOW RATE SUPPLY

T4 PUNTO BLU – THREADED

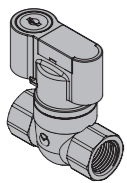

- PN10 (10 bar)
- 0-95 °C

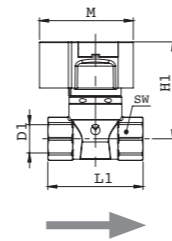

Code	DN	D1	L	H1	M	SW	Q l/min.	Pack
T403S11000	15	Rp1/2"	63	64	62	27	0.32	10
T404S11000	20	Rp3/4"	73	67	62	32	0.32	10

KEY FOR SECURITY LOCK

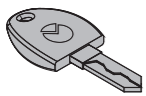

Code	Pack
KY5000	1

i Security keys are only supplied to authorised personnel.

